

SPECIFICATIONS

DIAL SIZE - 3 1/2 and 4 1/2 inch.
 CASE & RING - drawn stainless steel case with snap-in "O" ring gasketed clear lexan.
 DIAL - white coated aluminum with black markings.
 POINTER - slotted adjustable type.
 BOURDON TUBE - phosphor bronze.
 THERMAL BULB - copper.
 PROCESS CONN. FITTING - brass separable socket or aluminum air duct flange.
 ACCURACY - one scale division throughout range.

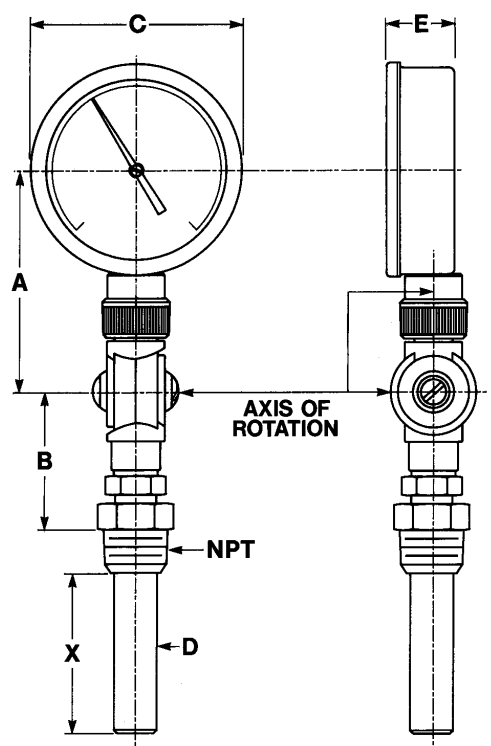

SOCKET W/ LAG EXTENSION

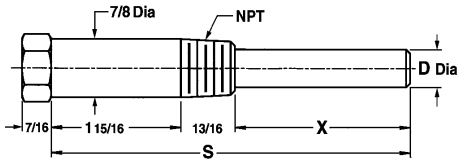

SOCKET CONN.

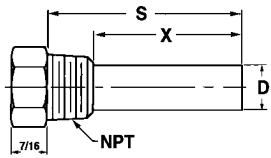

FLANGE CONN.

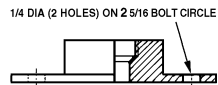

BULB NO. (CODE VI)	SOCKET CONNECTION			FLANGE CONN.	
	X	S	D	X	D
2	2 5/8	3 3/8	9/16	3	7/16
3	4 5/8	5 3/8	9/16	5	7/16

DIAL SIZE	A	B	C	E	D*	X LENGTH** FOR BULB NO. (CODE VI)			
						2	3	4	5
3 1/2"	3 7/8	2 9/16	3 11/16	1 1/4	9/16	2 5/8	4 5/8	6 5/8	8 5/8
4 1/2"	4 3/8	2 9/16	4 11/16	1 1/4	9/16				

°F RANGES
40-0-110°F
20-0-100°F
0-150°F
0-180°F
40-240°F
30-300°F
100-350°F

QTY.	CAT. NO.	DIAL DIA.	NPT	RANGE	TAG
	35VA3-0231	3 1/2"	1/2"		
	35VA3-0241	3 1/2"	3/4"		
	45VA3-0231	4 1/2"	1/2"		
	45VA3-0241	4 1/2"	3/4"		

NOTE: Dual Scales available.

NOTE: For Lag Extension Socket substitute 0351 (1/2" NPT) or 0361 (3/4" NPT).
 For Flange Fitting substitute last 2 end numbers with (75). Ex: 45VA 3 - 0 2 7 5

CUSTOMER _____

PROJECT _____

ENGINEER _____

PRO or P.O. NO. _____



WEISS INSTRUMENTS, INC.
 HOLTSVILLE, NEW YORK 11742

DESCRIPTION:

**Vari-angle® Vapor
 Actuated Dial Thermometer**

DRAWN BY: _____ DATE: _____ DRAWING: _____