

**PSN-B-50**

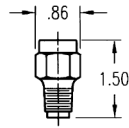

**PSN-B-25**

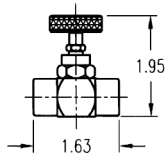

**25NVBR  
25NVSS**

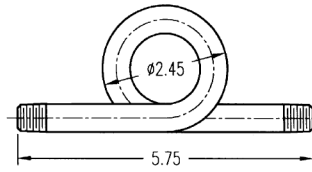

**SY-14B  
SY-14S**

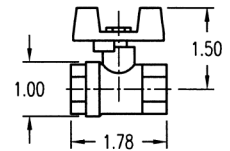

**BTC-14**

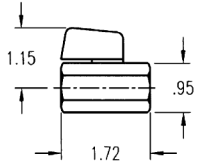

**BV25 BV50**

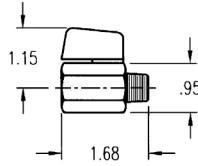

**MBV25**

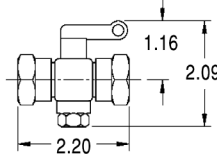

**LC-14**

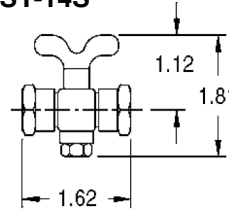

**TC-14** inch (mm) dimensions

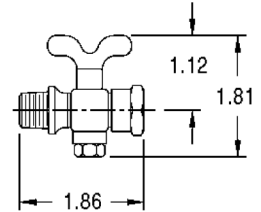

**MTC-14**

Quantity	<b>PRESSURE SNUBBERS</b>			
	CAT. NO.	SIZE	MATERIAL	RATING
	PSN-B-25	1/4" NPTM x 1/4" NPTF	Brass	1,500psi at 70°F
	PSN-B-50	1/2" NPTM x 1/2" NPTF	Brass	1,500psi at 70°F
	<b>NEEDLE VALVES</b>			
	CAT. NO.	SIZE	MATERIAL	RATING
	25NVBR	1/4" NPTF x 1/4" NPTF	Brass	600 psi & 300°F
	25NVSS	1/4" NPTF x 1/4" NPTF	304 SS	4000 psi & 150°F
	<b>SYPHONS</b>			
	CAT. NO.	SIZE	MATERIAL	RATING
	SY-14S	1/4" NPTM x 1/4" NPTM	Iron	300 psi & 300°F
	SY-14B	1/4" NPTM x 1/4" NPTM	Brass	400 psi & 300°F
	<b>FORGED BRASS COCKS</b>			
	CAT. NO.	SIZE	MATERIAL	RATING
	BTC-14	1/4" NPTF x 1/4" NPTF	Brass	200 psi Hydraulic
	BTC-12	1/2" NPTF x 1/2" NPTF	Brass	200 psi Hydraulic
	BLC-14	1/4" NPTF x 1/4" NPTF	Brass	200 psi Hydraulic
	BLC-12	1/2" NPTF x 1/2" NPTF	Brass	200 psi Hydraulic
	<b>GAUGE COCKS</b>			
	CAT. NO.	SIZE	MATERIAL	RATING
	TC-14	1/4" NPTF x 1/4" NPTF	Brass	200 psi Hydraulic
	LC-12	1/2" NPTF x 1/2" NPTF	Brass	200 psi Hydraulic
	LC-14	1/4" NPTF x 1/4" NPTF	Brass	200 psi Hydraulic
	MTC-14	1/4" NPTF x 1/4" NPTF	Brass	200 psi Hydraulic
	TC-34	3/4" NPTF x 3/4" NPTF	Brass	200 psi Hydraulic
	<b>BALL VALVES</b>			
	CAT. NO.	SIZE	MATERIAL	RATING
	BV25	1/4" FNPT x 1/4" FNPT	Chrome Plated Brass	450 psi & 250°F
	MBV25	1/4" FNPT x 1/4" MNPT	Chrome Plated Brass	450 psi & 250°F
	BV50	1/2" FNPT x 1/2" FNPT	Chrome Plated Brass	450 psi & 250°F

CUSTOMER \_\_\_\_\_

PROJECT \_\_\_\_\_

ENGINEER \_\_\_\_\_

PRO or P.O. NO. \_\_\_\_\_



**WEISS INSTRUMENTS, INC.**  
HOLTSVILLE, NEW YORK 11742

DESCRIPTION:

**GAUGE ACCESSORIES**  
Full Conformance with ASME B40.5

DRAWN BY: \_\_\_\_\_ DATE: \_\_\_\_\_ DRAWING: \_\_\_\_\_